



Detention Cabinets

Function

- Used to protect Fire Hose Rack Assemblies, Fire Extinguishers & Fire Dept. Valves, while maintaining maximum security - refer to chart

Standard Construction & Features

- 12 gauge solid steel door, 14 gauge tub & trim, white epoxy primed
- Heavy duty continuous hinge
- Recessed cabinets with heavy duty masonry anchors welded to frame
- Mortise cylinder prep., detention lock prep., or detention lock installed

Options

- Add prefix **SS** to cabinet model number for 14 gauge stainless steel door & trim
- Add prefix **FR** to cabinet model number for fire rated, **Fire-Rated**
- Add suffix **-RED** to cabinet model number for steel cabinets with red epoxy finish



2902-2936

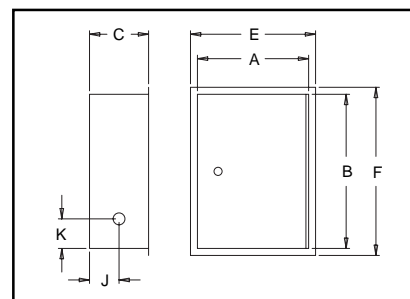

Model No.	Mounting Style	Trim	Dimensions								Accommodates Guardian Equipment		
			Box			Frame O.D.		K.O. Location		Wall Opening			
			A	B	C	E	F	J	K	Width	Height	Depth	
2902	Recessed	3/8"	10 1/2"	24"	6 1/2"	12 1/2"	26"	--	--	11 1/2"	25"	7"	Dry Chemical: 5, 6, & 10 lb. CO₂: 5 lb. Halotron1: 5lb
2904	Semi-Rec.	2 1/2"	10 1/2"	24"	6 1/2"	12 1/2"	26"	--	--	11 1/2"	25"	4 1/2"	
2906	Surface	8"	13"	26 1/2"	8"	13"	26 1/2"	--	--	--	--	--	
2912	Recessed	3/8"	12"	27"	8 1/2"	14"	29"	--	--	13"	28"	9"	Any Dry Chemical • CO₂: 5 & 10 lb. Any Halotron1 Water/Foam: 2 1/2 Gallon
2914	Semi-Rec.	2 1/2"	12"	27"	8 1/2"	14"	29"	--	--	13"	28"	6 1/2"	
2916	Surface	10"	14 1/2"	29 1/2"	10"	14 1/2"	29 1/2"	--	--	--	--	--	
2922	Recessed	3/8"	18"	18"	8 1/2"	20"	20"	3 1/2"	9"	19"	19"	9"	2 1/2" Fire Dept. Valve
2924	Semi-Rec.	2 1/2"	18"	18"	8 1/2"	20"	20"	4 1/4"	9"	19"	19"	6 1/2"	
2926	Surface	10"	20 1/2"	20 1/2"	10"	20 1/2"	20 3/4"	--	--	--	--	--	
2932	Recessed	3/8"	32 3/4"	34 3/4"	8"	34 3/4"	36 3/4"	4"	4"	33 3/4"	35 1/2"	8 1/2"	1 1/2" or 2 1/2" x 1 1/2" Hose Rack Assembly, plus 2 1/2" Fire Dept. Valve and Fire Extinguisher
2934	Semi-Rec.	2 1/2"	32 3/4"	34 3/4"	8"	34 3/4"	36 3/4"	4"	4"	33 3/4"	35 1/2"	6"	
2936	Surface	8"	36 3/4"	38 3/4"	8"	36 3/4"	38 3/4"	--	--	--	--	--	

Contact factory for *special* sizes and options

Detention Access Panels

Function

- Permit access for inspection or service to plumbing, heating, air conditioning, electrical & sprinkler system components, while maintaining maximum security

Standard Construction & Features

- 10 gauge plate steel door, 2" x 2" x 3/16" angle frame, rust-inhibitive gray primed
- Heavy duty hinges welded to door & frame
- Mortise cylinder prep., detention lock prep., or detention lock installed



2955-2990

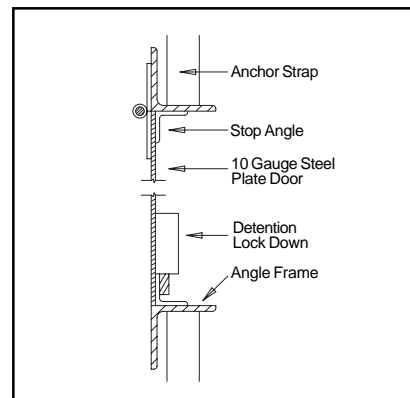

Model No.	Width x Height	Dimensions			
		Outside Width	Frame Height	Wall Opening Width	Wall Opening Height
2955	8" x 8"	12"	12"	8 3/4"	8 3/4"
2960	10" x 10"	14"	14"	10 3/4"	10 3/4"
2965	12" x 12"	16"	16"	12 3/4"	12 3/4"
2970	14" x 14"	18"	18"	14 3/4"	14 3/4"
2975	16" x 16"	20"	20"	16 3/4"	16 3/4"
2980	18" x 18"	22"	22"	18 3/4"	18 3/4"
2985	24" x 24"	28"	28"	24 3/4"	24 3/4"
2990	24" x 48"	28"	52"	48 3/4"	48 3/4"