



**Plugs and Break Caps**

- Used to keep fire dept. inlet connections free of debris and protect female threads, not intended for pressure application.

<b>Model 6402</b>	1½" cast brass* plug with chain
<b>Model 6404</b>	2½" cast brass* plug with chain
<b>Model 6406</b>	2½" aluminum break cap
<b>Model 6407</b>	2½" plastic break cap
<b>Model 6408</b>	2½" aluminum adjustable plug
<b>Model 6409</b>	2½" plastic adjustable plug

\*Optional brass finishes, add suffix to model no.

-B Polished; -C Rough Chrome Plated; -D Polished Chrome Plated

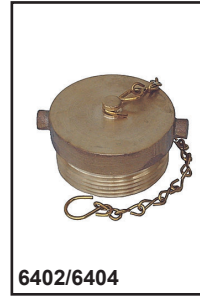

6402/6404

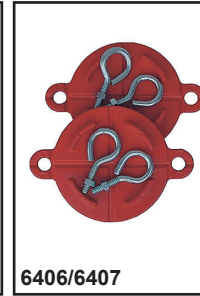

6406/6407

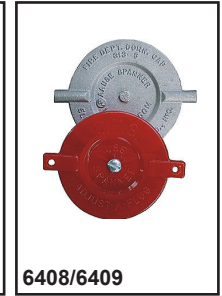

6408/6409

**Cover Sleeve**

- Used to conceal incoming pipe of free-standing fire department connection, polished brass\*

<b>Model 6414</b>	4" x 18"	<b>Model 6416</b>	6" x 18"
-------------------	----------	-------------------	----------

\*Optional polished chrome plated finish, add suffix -D to model no.



6414/6416

**Clappered Snoots**

- Used on fire department inlet connections to check backflow
- Cast brass body, polished trim\*

<b>Model 6418</b>	2½" female swivel inlet x 3" female NPT outlet
<b>Model 6419</b>	2½" female swivel inlet x 3" male NPT outlet

\*Optional polished chrome plated trim, add suffix -D to model no.



6418



6419

**Open Snoots**

- See Models 3340 and 3345, page 31

**Swing Check Valve**

- Used to prevent water backflow

<b>Model 6420</b>	4" groove x groove, cast brass
<b>Model 6421</b>	4" NPT male x groove, cast brass
<b>Model 6422</b>	4" NPT male x NPT female, cast brass

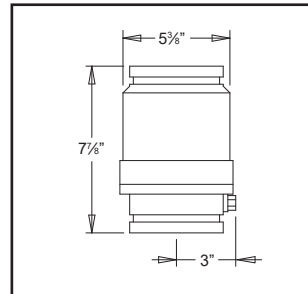

6420-6422

**Wafer Check Valve**

- Used to prevent water backflow

<b>Model 6426</b>	4" ductile iron*	<b>Model 6428</b>	6" ductile iron
-------------------	------------------	-------------------	-----------------

\*1/2" plug for ball drip on 4" only

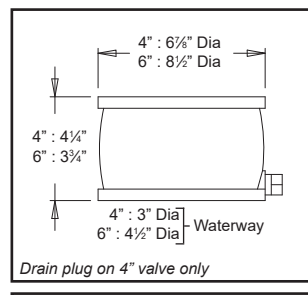

6426/6428

**Automatic Ball Drip**

- Used to drain water from the low point of the system

<b>Model 6430</b>	½" NPT, male x male, straight, cast brass
<b>Model 6431</b>	½" NPT, male x male, angle, cast brass
<b>Model 6432</b>	¾" NPT, male x male, straight, cast brass
<b>Model 6433</b>	¾" NPT, male x male, angle, cast brass



6430/6431



6435

**Sillcock**

- Used to manually drain water from the low point of the system

<b>Model 6435</b>	¾" female NPT x male GHT, cast brass*
-------------------	---------------------------------------

\*Optional rough chrome plated finish, add suffix -C to model no.