



**GUARDIAN**

FIRE EQUIPMENT, INC.  
MIAMI, FL

Ph. 800.327.6584 • Fax 800.827.3869

**DETAIL AND SUBMITTAL SHEET**

**Z4000 - Zurn Pressure Reducing Valve**

Project/Location: \_\_\_\_\_

Date: \_\_\_\_\_

Architect/Engineer: \_\_\_\_\_

Qty: \_\_\_\_\_

Contractor: \_\_\_\_\_

Appropriate Selection

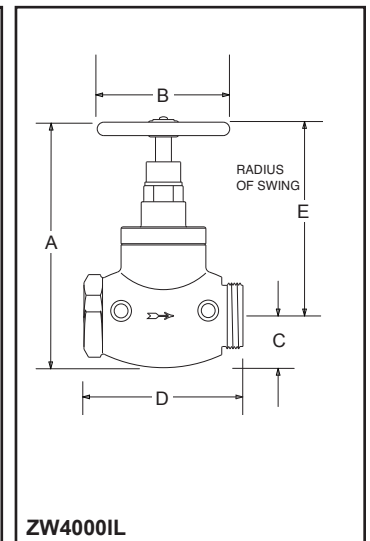
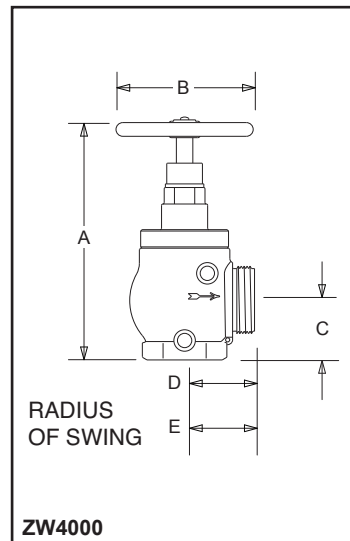
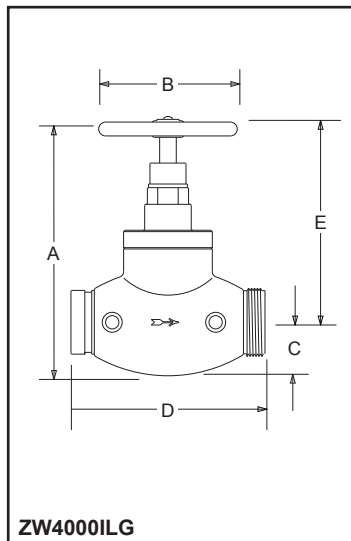
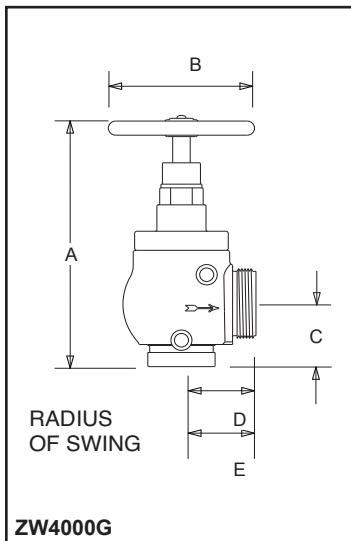

**Zurn Models Z4000** - Pressure reducing valve for standpipes at individual hose stations in CLASS I and CLASS III systems. Factory set, Regulates pressure under both FLOW and NO-FLOW conditions.

Model No.	A Open	A Closed	B	C	D	E	Weight
<input type="checkbox"/> Z4000	10 <sup>7</sup> / <sub>8</sub> "	10"	6 <sup>1</sup> / <sub>4</sub> "	2 <sup>3</sup> / <sub>4</sub> "	5 <sup>3</sup> / <sub>4</sub> "	3 <sup>3</sup> / <sub>16</sub> "	19
<input type="checkbox"/> Z4000IL	11 <sup>1</sup> / <sub>2</sub> "	10 <sup>1</sup> / <sub>2</sub> "	6 <sup>1</sup> / <sub>4</sub> "	2 <sup>3</sup> / <sub>8</sub> "	7 <sup>1</sup> / <sub>2</sub> "	8 <sup>3</sup> / <sub>16</sub> "	23
<input type="checkbox"/> Z4000G	11 <sup>5</sup> / <sub>16</sub> "	10 <sup>7</sup> / <sub>16</sub> "	6 <sup>1</sup> / <sub>4</sub> "	3 <sup>5</sup> / <sub>16</sub> "	3 <sup>3</sup> / <sub>16</sub> "	3 <sup>1</sup> / <sub>2</sub> "	18
<input type="checkbox"/> Z4000ILG	11 <sup>1</sup> / <sub>2</sub> "	10 <sup>1</sup> / <sub>2</sub> "	6 <sup>1</sup> / <sub>4</sub> "	2 <sup>3</sup> / <sub>8</sub> "	8 <sup>3</sup> / <sub>4</sub> "	8 <sup>3</sup> / <sub>16</sub> "	23
<input type="checkbox"/> Z4000SF	10 <sup>7</sup> / <sub>8</sub> "	10"	6 <sup>1</sup> / <sub>4</sub> "	2 <sup>3</sup> / <sub>4</sub> "	3 <sup>15</sup> / <sub>16</sub> "	3 <sup>1</sup> / <sub>2</sub> "	19

**Suffix Options:** IL - in-line (globe type) valve G - grooved inlet SF - San Francisco hose thread (3")

**Options:**  -B Polished Brass  -C Rough Chrome Plated  -D Polished Chrome Plated **Threads:**

NST  Other \_\_\_\_\_



**GUARDIAN**

FIRE EQUIPMENT, INC.  
MIAMI, FL

Ph. 800.327.6584 • Fax 800.827.3869

**DETAIL AND SUBMITTAL SHEET**

**Z4004 - Zurn Pressure Reducing Valve**

Project/Location: \_\_\_\_\_ Date: \_\_\_\_\_

Architect/Engineer: \_\_\_\_\_ Qty: \_\_\_\_\_

Contractor: \_\_\_\_\_

Appropriate Selection

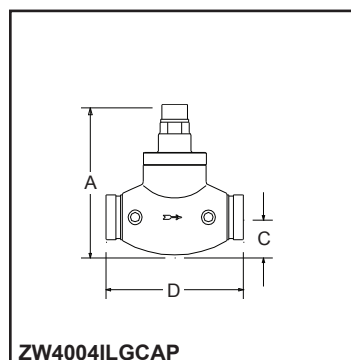
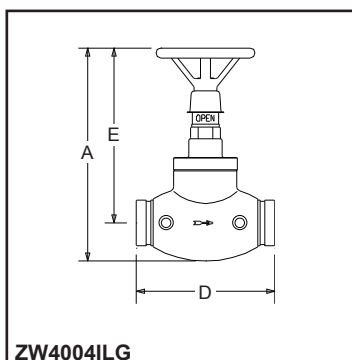
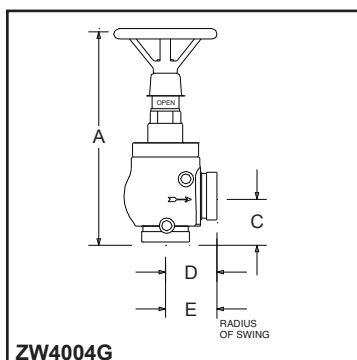
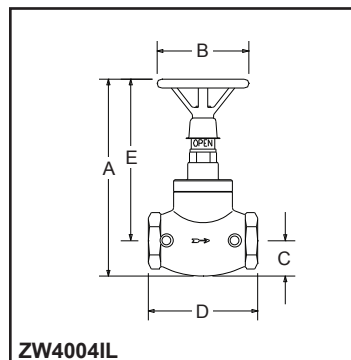
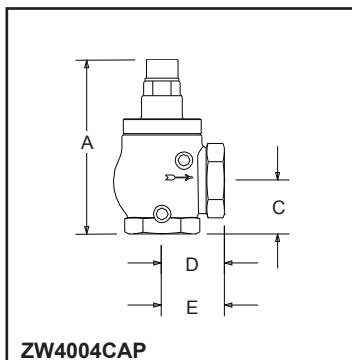
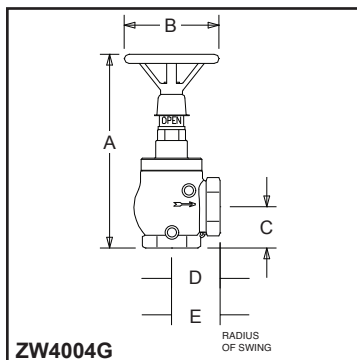

**Zurn Models Z4004** - Pressure reducing valve is listed as a floor control valve, indicating valve, and a check valve in automatic sprinkler systems; as well as a standpipe valve in CLASS I and CLASS III systems. Factory set, Regulates pressure under both FLOW and NO-FLOW conditions.

Model No.	A Open	A Closed	B	C	D	E	Weight
<input type="checkbox"/> Z4004	12 <sup>7</sup> / <sub>8</sub> "	12"	6 <sup>1</sup> / <sub>4</sub> "	2 <sup>3</sup> / <sub>4</sub> "	3 <sup>3</sup> / <sub>16</sub> "	3 <sup>5</sup> / <sub>8</sub> "	20
<input type="checkbox"/> Z4004IL	13 <sup>1</sup> / <sub>2</sub> "	12 <sup>1</sup> / <sub>2</sub> "	6 <sup>1</sup> / <sub>4</sub> "	2 <sup>3</sup> / <sub>8</sub> "	7 <sup>1</sup> / <sub>2</sub> "	8 <sup>3</sup> / <sub>16</sub> "	24
<input type="checkbox"/> Z4004G	13 <sup>5</sup> / <sub>16</sub> "	12 <sup>7</sup> / <sub>16</sub> "	6 <sup>1</sup> / <sub>4</sub> "	3 <sup>3</sup> / <sub>16</sub> "	3 <sup>3</sup> / <sub>16</sub> "	--	19
<input type="checkbox"/> Z4004ILG	13 <sup>1</sup> / <sub>2</sub> "	12 <sup>1</sup> / <sub>2</sub> "	6 <sup>1</sup> / <sub>4</sub> "	2 <sup>3</sup> / <sub>8</sub> "	8 <sup>3</sup> / <sub>4</sub> "	--	24
<input type="checkbox"/> Z4004CAP	9	--	--	2 <sup>3</sup> / <sub>4</sub> "	3 <sup>3</sup> / <sub>16</sub> "	3 <sup>3</sup> / <sub>5</sub> "	16
<input type="checkbox"/> Z4004ILCAP	7 <sup>1</sup> / <sub>4</sub> "	--	--	2 <sup>3</sup> / <sub>8</sub> "	7 <sup>1</sup> / <sub>2</sub> "	7 <sup>1</sup> / <sub>4</sub> "	20

Suffix Options: **IL** - in-line (globe type) valve **G** - grooved inlet **SF** - San Francisco hose thread (3")

Options:  -**B** Polished Brass  -**C** Rough Chrome Plated  -**D** Polished Chrome Plated

Threads:  NST  Other \_\_\_\_\_



**GUARDIAN**

FIRE EQUIPMENT, INC.  
MIAMI, FL

Ph. 800.327.6584 • Fax 800.827.3869

**DETAIL AND SUBMITTAL SHEET**

**Z4004SS - Zurn Pressure Reducing Valve**

Project/Location: \_\_\_\_\_

Date: \_\_\_\_\_

Architect/Engineer: \_\_\_\_\_

Qty: \_\_\_\_\_

Contractor: \_\_\_\_\_

Appropriate Selection

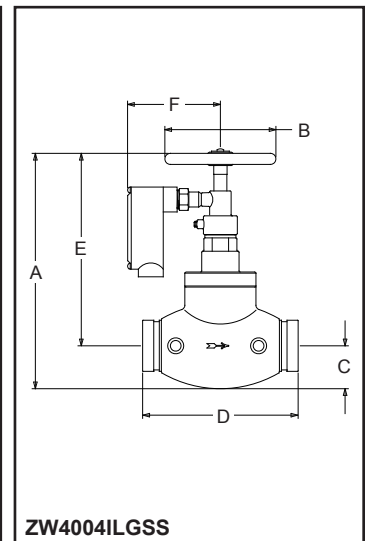
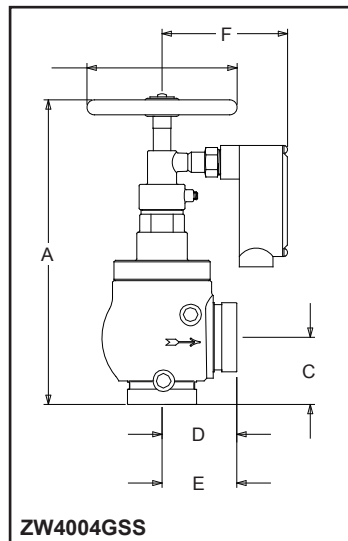
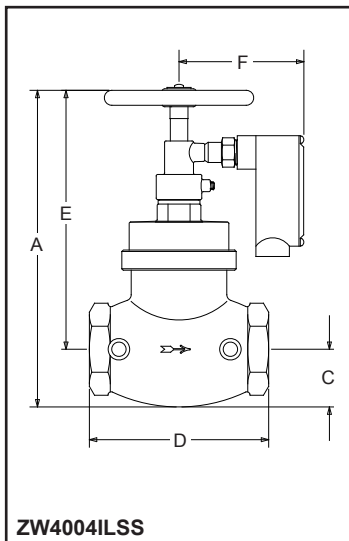
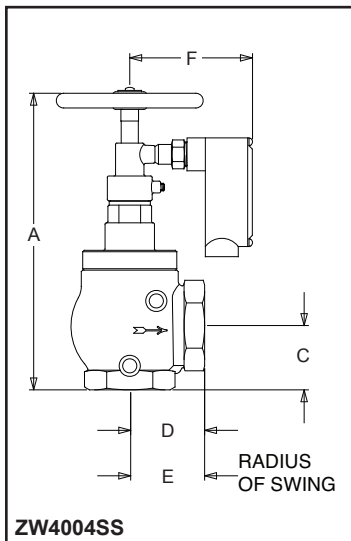

**Zurn Models Z4004SS** - Pressure reducing valve used as a floor control valve, an indicating valve, and a check valve in automatic sprinkler systems. Also used as a standpipe valve for CLASS I and CLASS III systems. Supervisory switch is built in. Suitable for indoor and outdoor use.

Model No.	A Open	B	C	D	E	F	Weight
<input type="checkbox"/> Z4004SS	12 <sup>7</sup> / <sub>8</sub> "	6 <sup>1</sup> / <sub>4</sub> "	2 <sup>3</sup> / <sub>4</sub> "	3 <sup>3</sup> / <sub>16</sub> "	3 <sup>5</sup> / <sub>8</sub> "	5 <sup>1</sup> / <sub>2</sub> "	21
<input type="checkbox"/> Z4004ILSS	13 <sup>1</sup> / <sub>2</sub> "	6 <sup>1</sup> / <sub>4</sub> "	2 <sup>3</sup> / <sub>8</sub> "	7 <sup>1</sup> / <sub>2</sub> "	11	5 <sup>1</sup> / <sub>2</sub> "	25
<input type="checkbox"/> Z4004GSS	13 <sup>5</sup> / <sub>16</sub> "	6 <sup>1</sup> / <sub>4</sub> "	3 <sup>3</sup> / <sub>16</sub> "	3 <sup>3</sup> / <sub>16</sub> "	--	5 <sup>1</sup> / <sub>2</sub> "	20
<input type="checkbox"/> Z4004ILGSS	13 <sup>1</sup> / <sub>2</sub> "	6 <sup>1</sup> / <sub>4</sub> "	2 <sup>3</sup> / <sub>8</sub> "	8 <sup>3</sup> / <sub>4</sub> "	--	5 <sup>1</sup> / <sub>2</sub> "	25

Suffix Options: **IL** - in-line (globe type) valve    **G** - grooved inlet

Options:  -**RB** Rough Brass     -**RC** Rough Chrome Plated

Threads:  NST     Other \_\_\_\_\_



**GUARDIAN**

FIRE EQUIPMENT, INC.  
MIAMI, FL

Ph. 800.327.6584 • Fax 800.827.3869

**DETAIL AND SUBMITTAL SHEET**

**ZW4100 - Zurn Pressure Reducing Valve**

Project/Location: \_\_\_\_\_

Date: \_\_\_\_\_

Architect/Engineer: \_\_\_\_\_

Qty: \_\_\_\_\_

Contractor: \_\_\_\_\_

*Appropriate Selection*

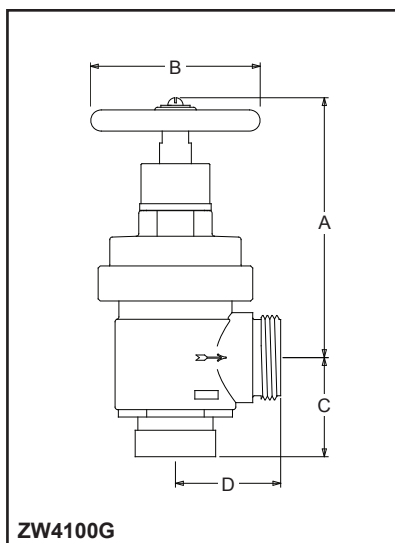
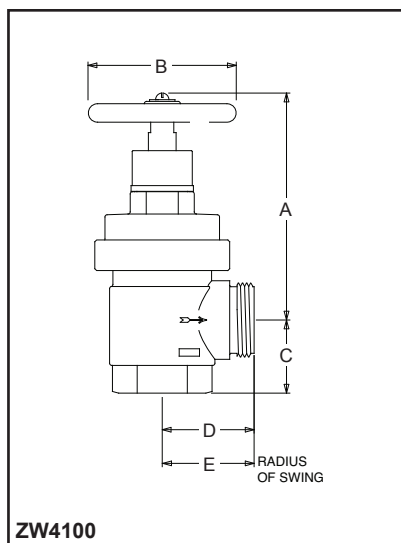

**Zurn Model ZW4100** - Pressure reducing valve listed as a standpipe valve for individual hose stations in CLASS II systems. Regulates pressure under both flow and no-flow conditions.

Model No.	A Open	A Closed	B	C	D	E	Weight
<input type="checkbox"/> ZW4100	6¾"	6⅛"	4"	2"	2½"	2⅝"	9
<input type="checkbox"/> ZW4100G	6¾"	6⅛"	4"	2⅜"	2½"	--	9

Suffix Options: **G** - grooved inlet

Options:  -RB Rough Brass     -C Rough Chrome Plated

Threads:  NST     Other \_\_\_\_\_



**GUARDIAN**

FIRE EQUIPMENT, INC.  
MIAMI, FL

Ph. 800.327.6584 • Fax 800.827.3869

**DETAIL AND SUBMITTAL SHEET**

**ZW4104 - Zurn Pressure Reducing Valve**

Project/Location: \_\_\_\_\_

Date: \_\_\_\_\_

Architect/Engineer: \_\_\_\_\_

Qty: \_\_\_\_\_

Contractor: \_\_\_\_\_

*Appropriate Selection*

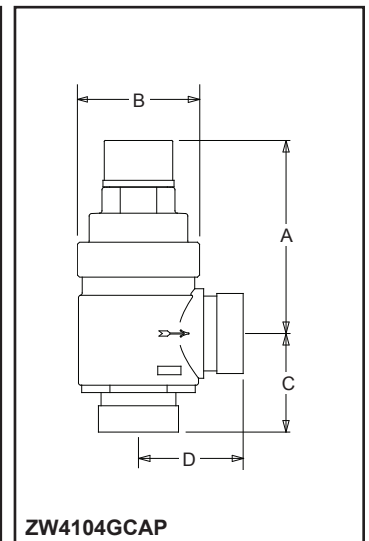
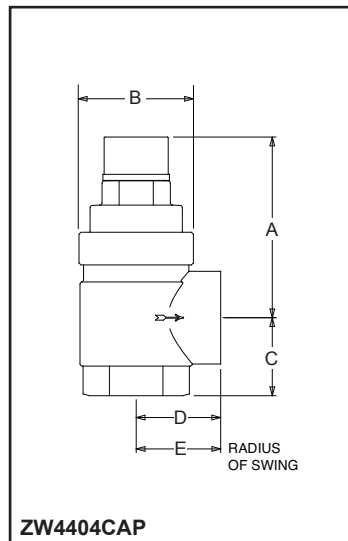
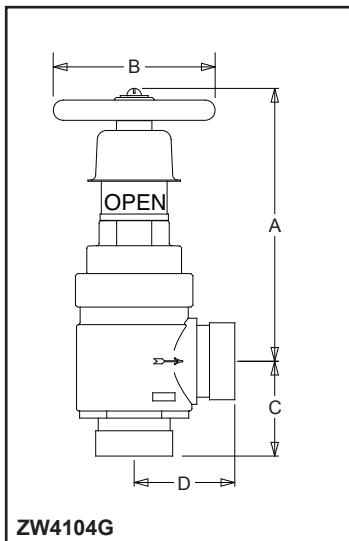
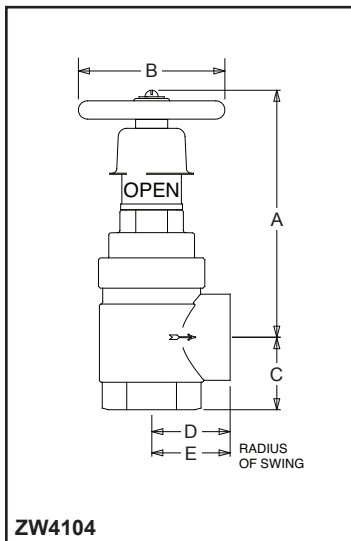

**Zurn Models ZW4104** - Pressure reducing valve is listed as a floor control valve, indicating valve and a check valve in automatic sprinkler systems. Also used as a standpipe valve for CLASS II systems. Regulates pressure under flow and no-flow conditions.

Model No.	A Open	A Closed	B	C	D	E	Weight
<input type="checkbox"/> ZW4104	6 <sup>3</sup> / <sub>4</sub> "	6 <sup>1</sup> / <sub>8</sub> "	4"	2"	2 <sup>3</sup> / <sub>16</sub> "	2 <sup>3</sup> / <sub>16</sub> "	9
<input type="checkbox"/> ZW4104G	6 <sup>3</sup> / <sub>4</sub> "	6 <sup>1</sup> / <sub>8</sub> "	4"	2 <sup>3</sup> / <sub>8</sub> "	2 <sup>1</sup> / <sub>2</sub> "	--	9
<input type="checkbox"/> ZW4104CAP	4 <sup>5</sup> / <sub>8</sub> "	--	3 <sup>3</sup> / <sub>4</sub> "	2"	2 <sup>3</sup> / <sub>16</sub> "	2 <sup>3</sup> / <sub>16</sub> "	8
<input type="checkbox"/> ZW4104GCAP	4 <sup>5</sup> / <sub>8</sub> "	--	3 <sup>3</sup> / <sub>4</sub> "	2 <sup>3</sup> / <sub>8</sub> "	2 <sup>1</sup> / <sub>2</sub> "	--	8

**Suffix Options:** **G** - grooved inlet    **-SS** - integral supervisory switch    **-MSA** - monitor switch adapter  
**CAP** - with capped bonnet

**Options:**  **-RB** Rough Brass     **-RC** Rough Chrome Plated

**Threads:**  **NST**     **Other** \_\_\_\_\_



**GUARDIAN**

FIRE EQUIPMENT, INC.  
MIAMI, FL

Ph. 800.327.6584 • Fax 800.827.3869

**DETAIL AND SUBMITTAL SHEET**

**ZW4104SS - Zurn Pressure Reducing Valve**

Project/Location: \_\_\_\_\_

Date: \_\_\_\_\_

Architect/Engineer: \_\_\_\_\_

Qty: \_\_\_\_\_

Contractor: \_\_\_\_\_

Appropriate Selection

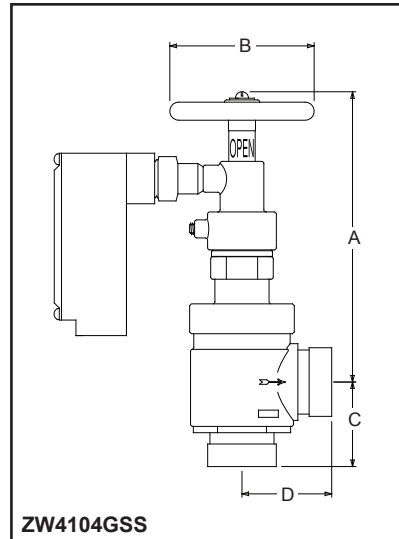
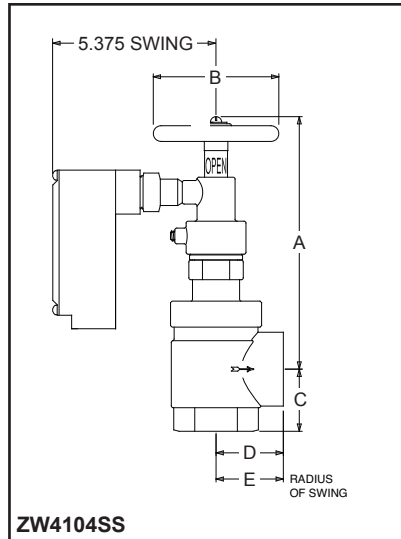

**Zurn Model ZW4104SS** - Pressure reducing valve listed as a floor control valve, indicating valve and a standpipe valve for CLASS II systems. Regulates pressure under flow and no-flow conditions. Supervisory switch built in.

Model No.	A Open	A Closed	B	C	D	E	Weight
<input type="checkbox"/> ZW4104SS	8"	7 <sup>3</sup> / <sub>8</sub> "	4"	2"	2 <sup>3</sup> / <sub>16</sub> "	2 <sup>3</sup> / <sub>16</sub> "	11
<input type="checkbox"/> ZW4100GSS	8"	7 <sup>3</sup> / <sub>8</sub> "	4"	2 <sup>3</sup> / <sub>8</sub> "	2 <sup>1</sup> / <sub>2</sub> "	--	11

Suffix Options: **G** - grooved inlet

Options:  -RB Rough Brass     -C Rough Chrome Plated

Threads:  NST     Other \_\_\_\_\_