



## Interior Cabinet Selection

**S  
T  
E  
P  
S**

- 1 Select cabinet series according to contents (page 4)
- 2 Select mounting style (page 5)
- 3 Select door & frame material (page 5)
- 4 Select door style (page 6)
- 5 Select hose rack assembly, fire extinguisher and/or fire dept. valve (page 7)

### Step 1 Select Cabinet Series According to Contents

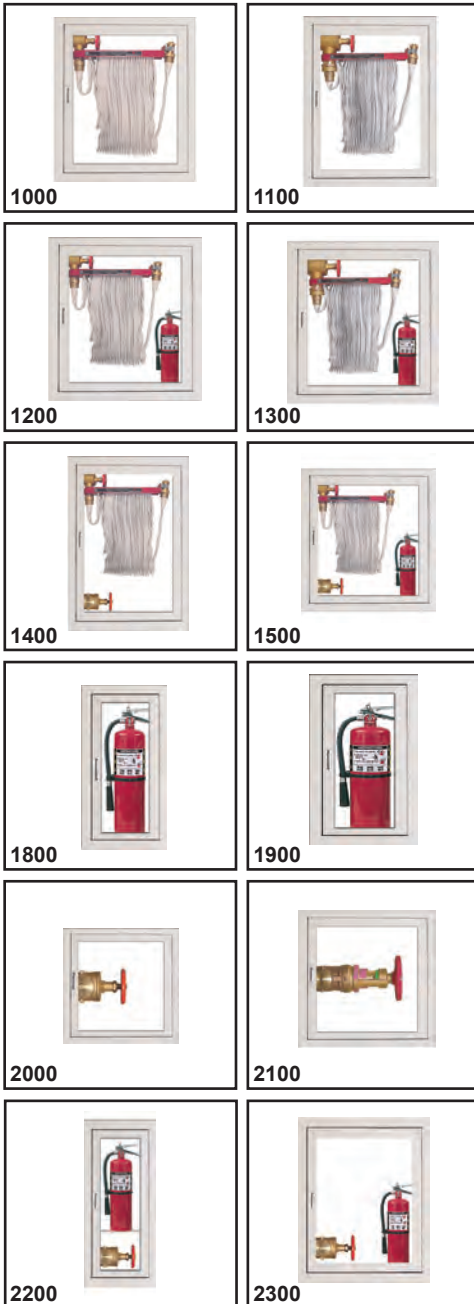

**1000** 1½" Fire Hose Rack Assembly

**1100** 2½" x 1½" Fire Hose Rack Assembly  
*Refer to pages 8 & 9 for details and dimensions*

**1200** 1½" Fire Hose Rack Assembly / Fire Extinguisher

**1300** 2½" x 1½" Fire Hose Rack Assembly / Fire Extinguisher  
*Refer to pages 10 & 11 for details and dimensions*

**1400** 1½" Fire Hose Rack Assembly / 2½" Fire Dept. Valve

**1500** 1½" Fire Hose Rack Assembly / 2½" Fire Dept. Valve and Fire Extinguisher  
*Refer to pages 12 & 13 for details and dimensions*

**1800** Fire Extinguisher

**1900** Fire Extinguisher  
*Refer to pages 14 & 15 for details and dimensions*

**2000** 2½" Fire Dept. Valve

**2100** 2½" Pressure Regulating Valve  
*Refer to pages 16 & 17 for details and dimensions*

**2200** 2½" Fire Dept. Valve / Fire Extinguisher

**2300** 2½" Fire Dept. Valve / Fire Extinguisher  
*Refer to pages 18 & 19 for details and dimensions*



**Step 2 Select Mounting Style**

**Recessed**

- Used where wall depth is sufficient to fully recess cabinet box
- Flat trim ( $\frac{3}{8}$ " ) covers rough wall opening
- Obstruction in traffic area is minimal

**Trimless**

- Used where wall depth is sufficient to fully recess cabinet box
- Frame is concealed behind finished wall, eliminating any obstruction in traffic area

*Not recommended for block wall installation*

**Semi-Recessed**

- Used where wall depths are limited
- Projecting trim covers rough wall opening
- Obstruction in traffic area will vary depending on cabinet series and wall depth

**Surface**

- Used where wall does not permit cabinet box to be recessed
- Practical for industrial and commercial remodeling
- Entire cabinet is in traffic area

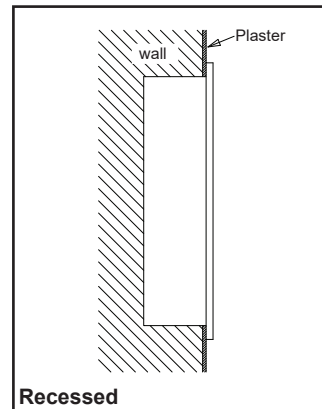

**Recessed**

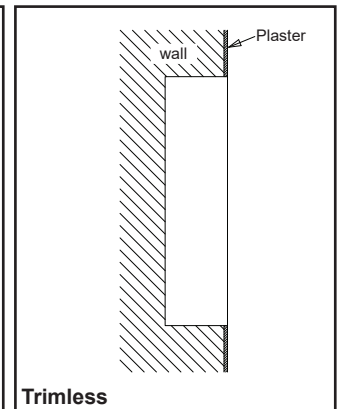

**Trimless**

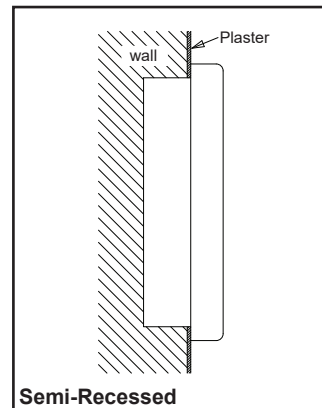

**Semi-Recessed**

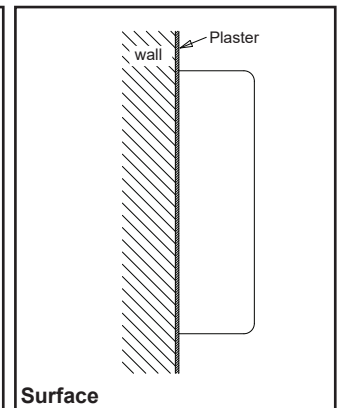

**Surface**

**Step 3 Select Door and Frame Material**

**Standard Construction & Features**

- One piece 20 gauge cold-rolled steel door and frame
- Door is reinforced with rigid tubular metal
- Continuous steel piano hinge and pin
- White baked acrylic enamel finish\*
- Door handle hardware

*\*Suitable as prime or finish coat*

**Optional Materials**

- **Aluminum** construction with clear anodized finish  
To specify aluminum, add prefix **AL** to cabinet model no.  
*Note: Color anodized is available, contact factory for details*
- **304 Stainless Steel** construction with #4 brushed finish  
To specify stainless steel, add prefix **SS** to cabinet model no.
- **Solid Brass or Bronze** construction with #4 satin finish  
To specify brass, add prefix **B** to cabinet model no.  
To specify bronze, add prefix **BZ** to cabinet model no.
- **Red Baked Acrylic Enamel** finish for steel cabinets  
To specify red, add suffix **-RED** to cabinet model number  
*Note: Trimless, recessed and semi-recessed cabinets maintain white boxes.*



## Step 4 Select Door Style - Add suffix to cabinet model number

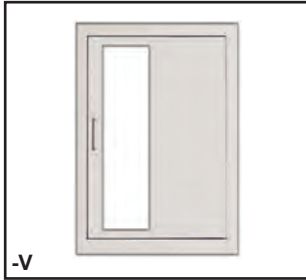
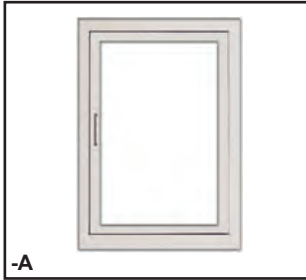

**-A**

**Full Glass** - Complete view of cabinet contents  
*Standard Glazing: clear acrylic with door handle hardware*

**-F**

**Solid Metal** - Full concealment of cabinet contents  
*Standard: solid door with door handle hardware*  
*Aluminum -F supplied with -A style frame and full aluminum insert.*

**-D**

**Duo Panel** - Horizontal view of cabinet contents  
*Standard Glazing: clear acrylic with door handle hardware*

**-V**

**Vertical Duo Panel** - Vertical view of cabinet contents  
*Standard Glazing: clear acrylic with door handle hardware*

### Optional Glazing: Specify by adding to door style description

- Double Strength Glass
- Wire Glass
- Tempered Glass
- Bubble - For Cabinets with Extinguishers

### Optional Door Lettering: Specify by adding details to door style description

Decals or die-cut letters for vertical or horizontal applications in colors red, black, or white

- Fire Hose
- Fire Dept Valve
- Fire Extinguisher

*Refer to page 21 for details*

### General Information

A cabinet's door design must allow for quick and safe access. Non-locking doors with door handle hardware are standard, and suitable for most installations.

Where security of cabinet contents is a concern, a locking door may be required. Break-glass panel door styles have been utilized. However, due to growing injury and liability concerns, this door style has become less popular.

### **\*NEW**

With the introduction of the **SAFETY-LOCK** cam lock, it is possible to open a locked cabinet without breaking glass. A forceful pull on the door handle will permit access to cabinet contents. Furnished with the **SAFETY-LOCK** cam lock and instructional decal. Door styles may be specified with the **SAFETY-LOCK** cam lock option, by adding suffix **-SL** to the cabinet model number.



**Step 5** Select Hose Rack Assembly, Fire Extinguisher and/or Fire Dept. Valve

- Refer to pages 28 & 29 for hose rack assembly details
- Refer to pages 43 to 45 for fire extinguisher details
- Refer to pages 50 to 53 for fire dept. valve details



**Additional Information**

**Fire-Rated Cabinets with Fire FX™ Option**

Cabinets fabricated in accordance with the **WARNOCK HERSEY** design\* are certified and listed for use in 1 and 2-hour combustible and non-combustible wall systems.

*\* Per UBC standard 43-6 (ASTM-814) under pressure to measure fire resistive performance.*

**Advantages:**

- Maintain wall integrity without having to insulate rough wall opening with fire-rated material
- Eliminate guesswork as to whether fire barrier has been compromised and saves installer considerable time and expense
- Appropriate for either new construction or renovation projects

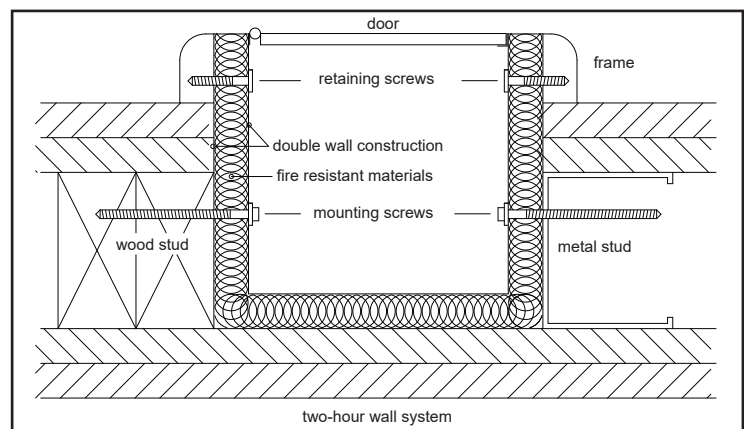
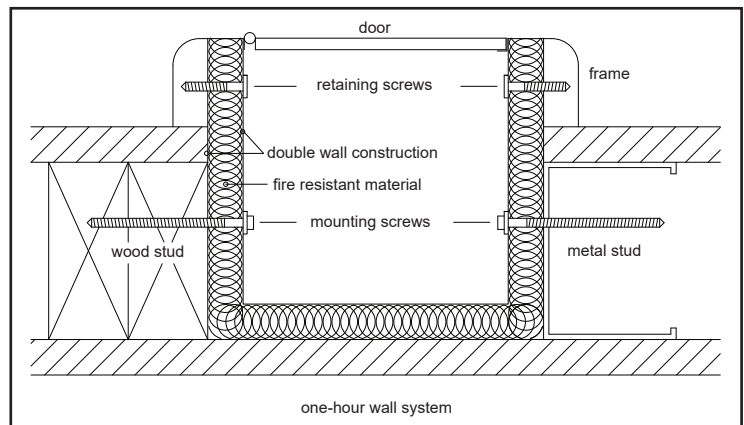

**A.D.A. & Cabinet Compliance**

The Americans with Disabilities Act (A.D.A.) of 1990 mandates that cabinets or other accessories not extend into corridor areas more than 4".

Cabinet models complying with A.D.A. requirements are designated with a check (✓) in the series dimension tables.