



GUARDIAN

FIRE EQUIPMENT, INC.
MIAMI, FL

Ph. 800.327.6584 • Fax 800.827.3869

DETAIL AND SUBMITTAL SHEET

5200 Series - Pressure Regulating Valves (Factory Set)

Project/Location: _____

Date: _____

Architect/Engineer: _____

Qty: _____

Contractor: _____

Appropriate Selection

Used to regulate and control high pressures in standpipe and sprinkler systems. Constant pressure regulation under residual (flowing) and static (non-flowing) conditions. Tamper-proof pressure setting (Factory Set). Valve seat acts as checking device and closes when inlet pressures drop below selected static outlet pressures.

Angle type 1 1/2" and 2 1/2", inline (straight) type 2 1/2" size. Female pipe inlet x female pipe or male hose thread outlet. Cast brass body with brass and stainless steel internals. 1 1/2" UL listed 300 PSI, 2 1/2" UL listed 400 PSI pressure. Optional monitor switch adapter bracket permits valve supervision by electrical means.

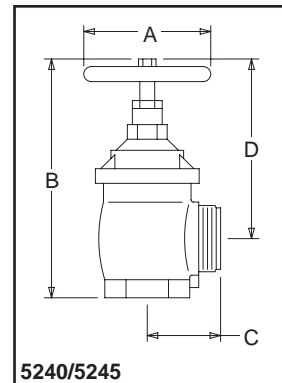

5240/5245

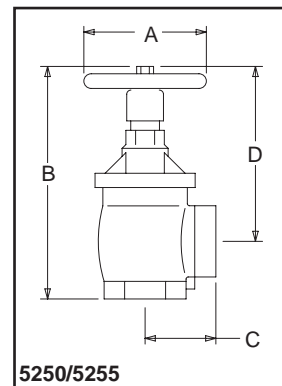

5250/5255

Model No.	Size	Outlet	A	B	C	D
<input type="checkbox"/> 5240	1 1/2" x 1 1/2"	Male*	4"	7 3/4"	2 1/4"	5 3/4"
<input type="checkbox"/> 5245	2 1/2" x 2 1/2"	Male*	5"	10 5/8"	3 1/4"	8"
<input type="checkbox"/> 5250	1 1/2" x 1 1/2"	Female NPT	4"	7 3/4"	2 1/4"	5 3/4"
<input type="checkbox"/> 5255	2 1/2" x 2 1/2"	Female NPT	5"	10 5/8"	3 1/4"	8"
<input type="checkbox"/> 5260	2 1/2" x 2 1/2"	Female NPT	5"	11 3/4"	7 1/2"	10"

Optional Finish: -C Rough Chrome Plated

*Threads: NST Other _____

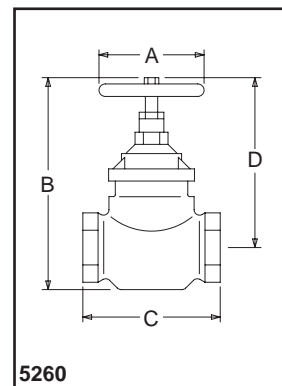

5260

Caps with Chains - Used to protect hose thread outlets on valves and hydrants. Cast brass caps (pin lugs)* or red plastic caps (rocker lugs).

Model No.	Size	Type
<input type="checkbox"/> 5515	1 1/2"	Brass
<input type="checkbox"/> 5515P	1 1/2"	Plastic
<input type="checkbox"/> 5525	2 1/2"	Brass
<input type="checkbox"/> 5525P	2 1/2"	Plastic

Threads:

- NST
 Other _____

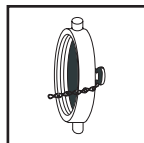

Optional Finish: -C Rough Chrome Plated

*Optional: -RL Rocker lugs

Options

-bkt2 - Bracket used for supervisory switch installation.

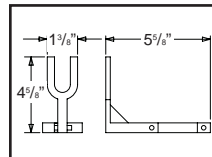

9391 Supervisory Switch - Used to detect tampering or setting changes on control valves.

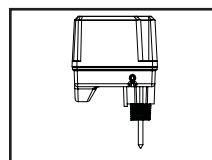

Reducer - Used to change outlet size. Rigid pin lug*, female x male threads.

Model No.	Size
<input type="checkbox"/> 3315	2 1/2" x 1 1/2"

Threads:

- NST
 Other _____

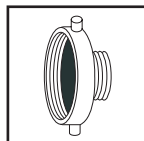

Optional Finish: -C Rough Chrome Plated

*Optional: -RL Rocker lugs