



**GUARDIAN**

FIRE EQUIPMENT, INC.  
MIAMI, FL

Ph. 800.327.6584 • Fax 800.827.3869

**DETAIL AND SUBMITTAL SHEET**

**6800 Series - Free-Standing Pump Test Connections**

Project/Location: \_\_\_\_\_

Date: \_\_\_\_\_

Architect/Engineer: \_\_\_\_\_

Qty: \_\_\_\_\_

Contractor: \_\_\_\_\_

*Appropriate Selection*

Used to conduct flow tests on fire pumps.

**Two and three-way** test connections feature brass bodies with female NPT inlets and outlets.

**Four and Six-way** test connections feature brass bodies with female NPT inlets and outlets.

**Standard Components, all connections:**

N.R.S. gate valves (2 1/2" female NPT x 2 1/2" male hose thread), caps with chains, 18" cover sleeve and identification plate lettered "PUMP TEST". Cast brass construction, standard.

*Four and six-way bodies furnished with 3" male NPT x 2 1/2" male NPT outlet snoots and "loose bonnet" gate valves.*

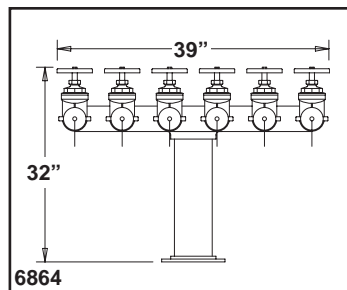
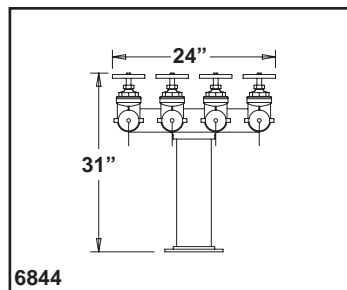
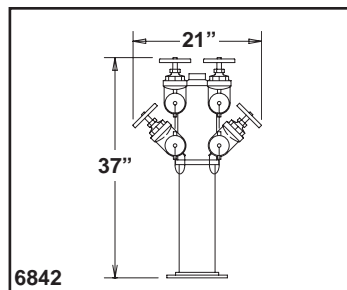
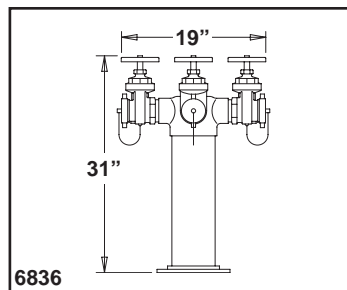
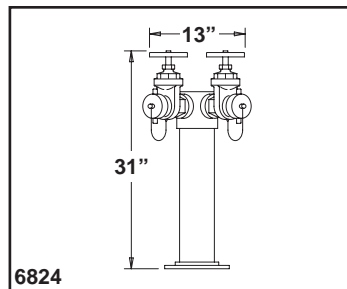

Two, Three Four and Six-Way Connectionse			
Model No.	Size	Overall Height	Radius of Body Swing
<input type="checkbox"/> 6824	4" x 2 1/2" x 2 1/2"	31"	5"
<input type="checkbox"/> 6826	6" x 2 1/2" x 2 1/2"	31"	6"
<input type="checkbox"/> 6836	6" x 2 1/2" x 2 1/2" x 2 1/2"	31"	5 1/2"
<input type="checkbox"/> 6842	6" x 2 1/2" square, 4-way	37"	7 1/2"
<input type="checkbox"/> 6844	6" x 2 1/2" in-line, 4-way	31"	12 1/2"
<input type="checkbox"/> 6864**	8" x 2 1/2" in-line, 6-way	32"	19"

\*\* With steel body only

Optional Finish:  -B Polished Brass  
 -C Rough Chrome Plated  
 -D Polished Chrome Plated

Threads:  NST  
 Other

**Component Variations**

- ST Bodies fabricated of schedule 40 steel with female NPT inlets and 2 1/2" female NPT outlets\*  
*\*2 1/2" x 2 1/2" outlet snoots required*
- 1 Standard components, except outlets with 2 1/2" male hose threads (bodies/snoots) and less valves.
- 2 Standard components, except outlets with 2 1/2" male hose threads (bodies/snoots), and N.R.S. swivel inlet gate valves (2 1/2" female hose thread x 2 1/2" male hose thread).  
*Swivel inlet gate valves always furnished cast brass.*