



GUARDIAN

FIRE EQUIPMENT, INC.
MIAMI, FL

Ph. 800.327.6584 • Fax 800.827.3869

DETAIL AND SUBMITTAL SHEET

6900 Series - Rooftop Outlet Connections

Project/Location: _____

Date: _____

Architect/Engineer: _____

Qty: _____

Contractor: _____

Appropriate Selection

Used as auxiliary connections to supply water for fire department use and for testing of standpipe system. Provides 250 GPM flow (minimum), per 2 1/2" outlet.

Two and three-way outlet connections feature brass bodies (straight or angle patter), with female NPT inlets and male NPT outlets (female NPT outlets on Models 6944/6946). Cast brass construction, standard.

Two and Three-Way Connections				
Model No.	Inlet	Size	A	B
<input type="checkbox"/> 6924	Back	4" x 2 1/2" x 2 1/2"	6 5/8"	4 3/4"
<input type="checkbox"/> 6925	Angle	4" x 2 1/2" x 2 1/2"	6 3/4"	5 3/4"
<input type="checkbox"/> 6926	Back	6" x 2 1/2" x 2 1/2"	8 1/4"	6 3/8"
<input type="checkbox"/> 6927	Angle	6" x 2 1/2" x 2 1/2"	9"	8 1/2"
<input type="checkbox"/> 6935	Angle	4" x 2 1/2" x 2 1/2" x 2 1/2"	13 1/2"	10 1/2"
<input type="checkbox"/> 6936	Back	6" x 2 1/2" x 2 1/2" x 2 1/2"	10 1/4"	10 5/8"
<input type="checkbox"/> 6837	Angle	6" x 2 1/2" x 2 1/2" x 2 1/2"	10 1/2"	9"

Optional Finish: -B Polished Brass
 -C Rough Chrome Plated
 -D Polished Chrome Plated

Threads:
 NST
 Other

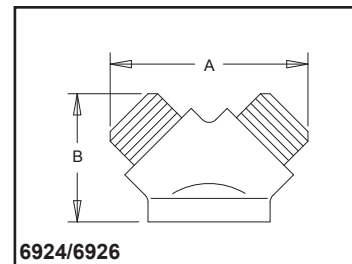

6924/6926

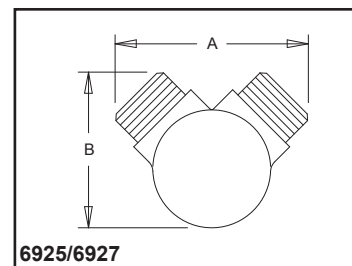

6925/6927

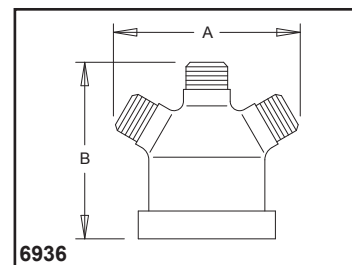

6936

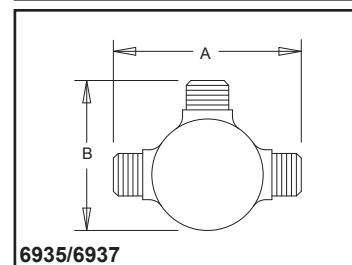

6935/6937

Component Variations

- 1 Standard bodies, complete with Model 5015 angle valves and Model 5525 caps for each outlet.
- 2 Standard bodies, complete with Model 5110 gate valves and Model 5525 caps for each outlet.
- 3 Standard bodies, complete with Model 5310 globe valves and Model 5525 caps for each outlet.
- NST Bodies with male hose thread outlets.
Overall dimensions may apply